

Sampling + Draining Valve Type PRB-HA

Connecting Port according	ISO228
Thread	G 3/8" - G 1/2"
nominal pressure	max. 16 bar
Operating max. Temperature	50 ° C

Designation	Material
Housing	stainless steel
flue pipe	stainless steel
needle	stainless steel
handwheel	aluminium coated



For Water sampling and draining in water plants, water treatment plants, reservoir-tanks, flammable version, applicable up to 16 bar.

Valvebody and flammable-pipe material stainless steel, operated by hand wheel easily mounting in sockets.

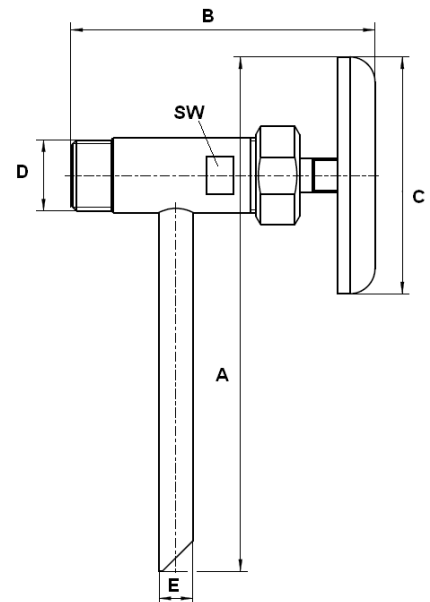

D	A	SW	B	E	C	Netweight
["]	[mm]		[mm]	[mm]	[mm]	kg
3/8	152	19	90	10	70	0,29
1/2	152	19	90	10	70	0.29